

N<sup>o</sup> 95.

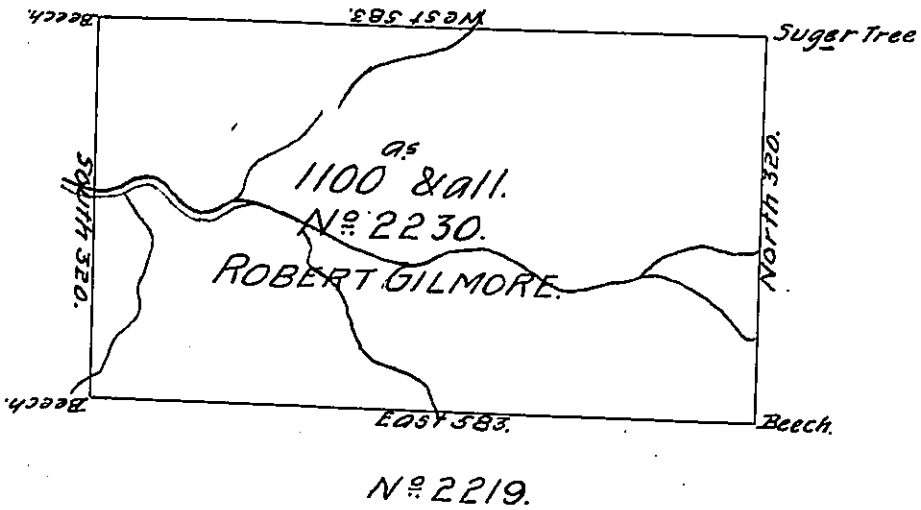

Situate two Miles South of the State Line and about two Miles East of the Alleg-  
 any River in North<sup>d</sup> County, containing 1100 <sup>as</sup> & the usual allowance for Roads-  
 Surveyed June 18<sup>th</sup> 1793 for Robert Gilmore in persewance of a Warrant  
 December  
 N<sup>o</sup> 2230 bearing date 12<sup>th</sup> 1792.

John Canan,

Daniel Brodhead Esq. S. G.

D. S.

IN TESTIMONY that the above is a copy of the original remaining on file in  
 the Department of Internal Affairs of Pennsylvania, made  
 conformably to an Act of Assembly approved the 16th day of  
 February, 1833, I have hereunto set my Hand and caused  
 the Seal of said Department to be affixed at Harrisburg,  
 this first day of November 1904.

*Loae P. Brown*  
 Secretary of Internal Affairs.